

**TAPPI CONICI IN ACCIAIO BRUNITO
E IN OTTONE**
CONICAL PLUG IN SMOKED STEEL AND BRASS

CODICE / Item no.
DIN906

Materiale: Acciaio Classe 10.9
Material: Steel Class 10.9

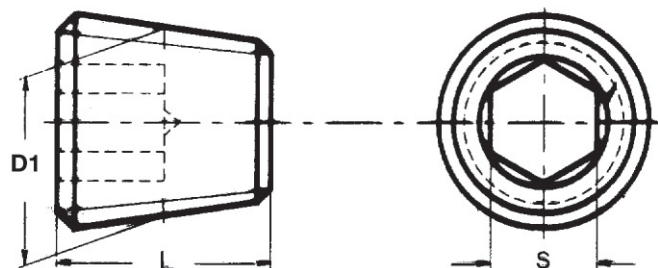

D1	L	S	
1/8 GAS	9,78	3/16	—
1/4 GAS	12,9	1/4	—
3/8 GAS	14,5	5/16	—
1/2 GAS	17,7	3/8	—

ESEMPIO DI ORDINAZIONE DIN906 D
ORDERING EXAMPLE DIN906 D