

ESPULSORE LAMELLARE TEMPRATO DIN/ISO 8693

HARDEND FLAT EJECTOR PIN DIN/ISO 8693

CODICE / Item no.

A106

Materiale: Acciaio legato da utensili (WS)

Material: Alloy steel tool (WS)

Esecuzione: Temprato, ribasso rettificato, testa riscalcata a caldo
Execution: Tempered, adjusted downward, head modeled hot

Durezza: Stelo e ribasso 58...62 Rc
testa 40...50 Rc

Hardness: Stem and downward 58...62 Rc
head 40...50 Rc

FORMA FWS

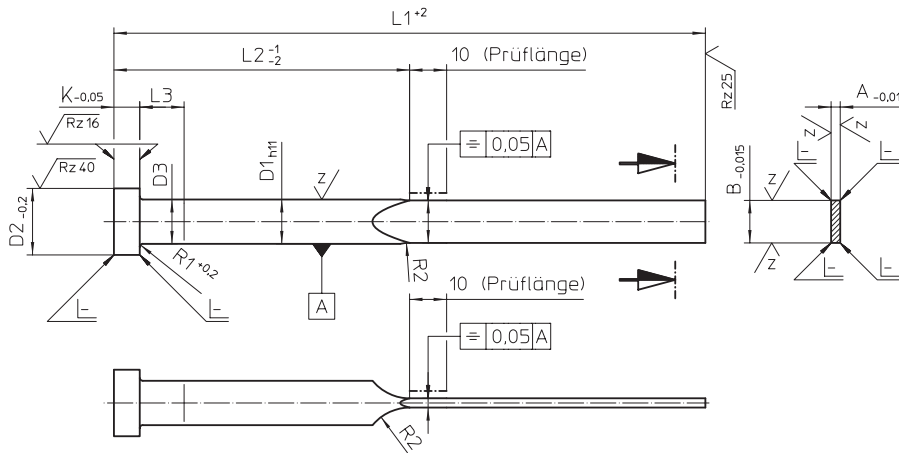

ESEMPIO DI ORDINE:

10 PEZZI A106 3,8 x 1,2 x 160

ORDERING - EXAMPLE:

10 PIECES A106 3,8 x 1,2 x 160

b x a	d ₁	d ₂	k	r ₁	d ₃	l ₃	63	80	100	125	160	200	250	315	Lunghezza totale l ₁₊₂	Lunghezza gambo l _{2-1/-2}	Lunghezza ribasso ≈				
							32	40	50	63	80	100	125	160							
-0,015	-0,1	-0,2	-0,05	+0,2																	
3,5 x 1,0	4,00	8	3	0,3	d ₁ +0,03	5	♦	♦	♦	♦											
3,8 x 0,8							♦	♦	♦	♦											
3,8 x 1,0	4,20	♦	♦	♦			♦	♦	♦												
3,8 x 1,2		♦	♦	♦			♦	♦	♦	♦											
4,5 x 1,0		♦	♦	♦			♦	♦	♦	♦	♦										
4,5 x 1,2	5,00	10						♦	♦	♦	♦	♦									
4,5 x 1,5									♦	♦	♦	♦	♦								
5,5 x 1,0								♦	♦	♦	♦	♦	♦								
5,5 x 1,2	6,00	12	5	0,5		d ₁ +0,04	6		♦	♦	♦	♦	♦	♦							
5,5 x 1,5									♦	♦	♦	♦	♦	♦	♦						
5,5 x 2,0										♦	♦	♦	♦	♦	♦	♦					
7,5 x 1,2											♦	♦	♦	♦	♦						
7,5 x 1,5	8,00	14									♦	♦	♦	♦	♦						
7,5 x 2,0												♦	♦	♦	♦	♦					
9,5 x 1,5													♦	♦	♦	♦					
9,5 x 2,0	10,00	16										♦	♦	♦	♦						
11,5 x 2,0	12,00	18	7	0,8									♦	♦	♦						
11,5 x 2,5																♦	♦	♦			

SI FORNISCONO ESPULSORI A LAMELLA IN ACCIAIO PER LAVORAZIONE A CALDO.
YOU PROVIDE EJECTOR BLADE STEEL FOR HOT WORK.

LE MISURE SPECIALI SONO FORNIBILI SU RICHIESTA.
SPECIAL MEASURES ARE AVAILABLE ON REQUEST.